



Series 4-OR

User Guide



Tested To Extremes



Minnesota Thermal Science

3020 Niagara Lane

Plymouth MN, 55447

Made in the U.S.A.

www.credothermal.com

Tel: (877) 537-9800

Fax: (763) 412-4801

SPECIFICATION SHEET

Series 4-OR



Product Overview

Operating room container designed to safely and efficiently store blood surgery.

Maintains the FDA-required storage temperature of 1° to 6°C for over 12 hours so that unused blood may be returned to supply. Reusable, iceless container simplifies the preparation and maintenance of blood or other chilled medical materials in hospitals, clinics and laboratories.

Specifications

Temperature Range	1° - 6°C
Payload Capacity (Liters/Cubic Inches)	2/127.5
Payload Area Dimensions (LxWxH)	6"x5"x4.25"
Exterior Dimensions (LxWxH)	13"x9.5"x8.5"
Tare Weight	9 LBS
Thermal Performance (ISTA Summer Profile)	12+ Hrs at 20°C
Insulator	Cellular Insulated Igloo Cooler

Ensuring Consistent Performance

Exterior Ambient Conditions	Holds Payload 1° - 6°C
Constant 20°C ambient	12+ Hours
ISTA 7D shipping profile	N/A
*Performance based on full payload preconditioned at 4°C	

- Always precondition TIC System before use according to instructions on TIC lid.
- Ensure all components are clean and not damaged.
- Follow assembly instructions specified in the user guide.
- After loading, avoid opening container unnecessarily.
- Ensure all components are clean after each use. Components are dishwasher safe.

Product Components

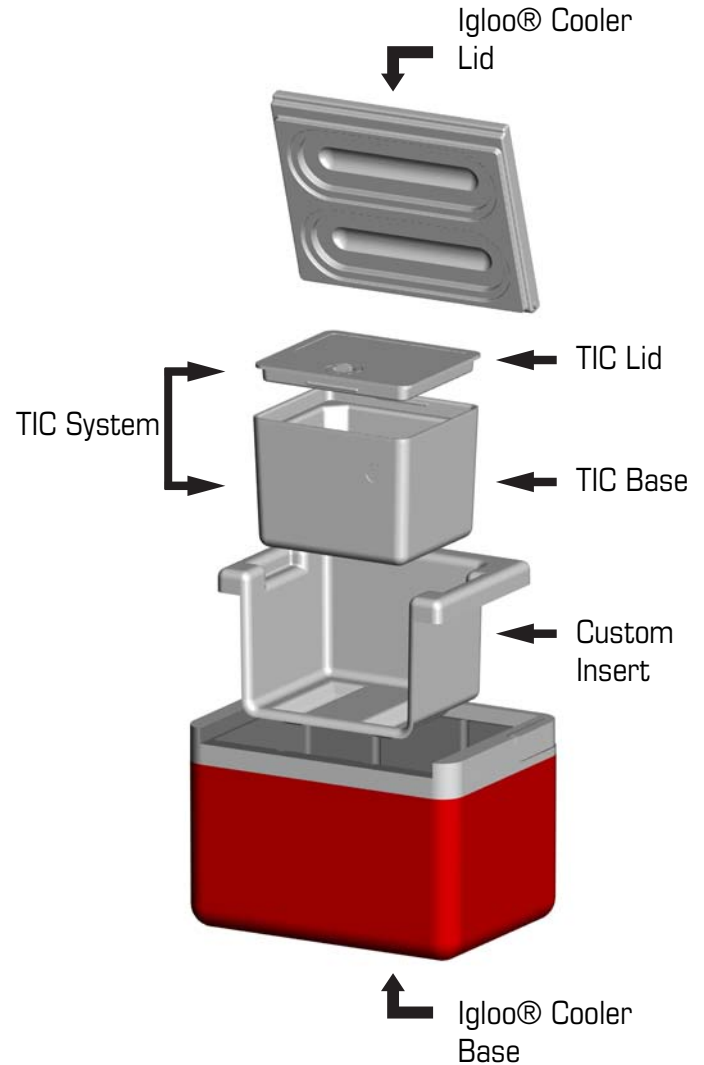

ISTA Thermal Performance

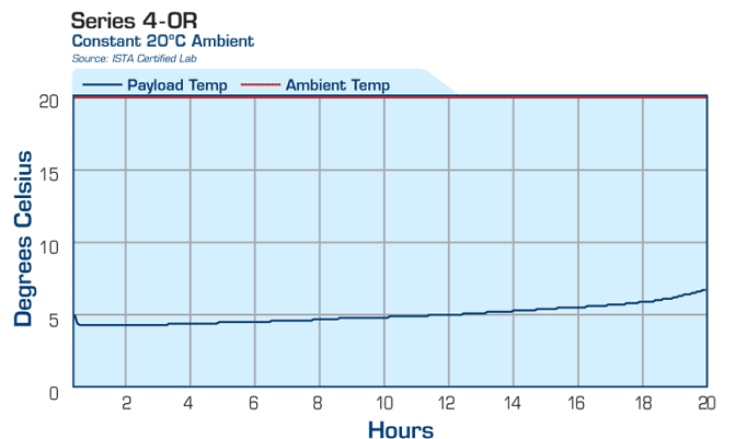

USING YOUR CREDO THERMAL PACKAGING SOLUTION

Series 4-OR



1



Precondition TIC® System

- Remove TIC® (Thermal Isolation Chamber) System (lid and base) from the Igloo cooler by opening the lid of the cooler.
- Place TIC System in a -18°C freezer (or colder) for a minimum of 8 hours, until frozen hard. Separate TIC lid from TIC base during preconditioning. Before adding product payload, let stand at room temperature for 25 minutes or until surface frost melts.
- **Optional Storage Method:** After TIC System preconditioning, it may be refrigerated to be ready for immediate use. The TIC System may be refrigerated up to 48 hours before needing to be reconditioned. Verify refrigerator is set at 4°C or below.

2

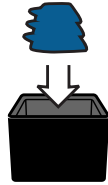

Load Payload

- Ensure payload (product to be kept chilled) is preconditioned at 4°C before loading into TIC base. Do not overpack.

3

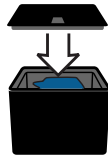

Secure TIC System

- Place TIC lid over payload, ensure lid lies flat without forcing onto TIC base.

4

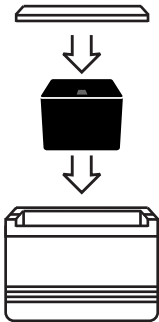

Assemble Credo OR Container

- Lower TIC System into the cooler's custom insert. Verify that insert is all of the way down into the cooler.
- Snap Igloo cooler lid into place by lining up the hinge points molded into the cooler lid and cooler base.
- Gently snap the cooler lid into place and verify that it swings open and close.

5

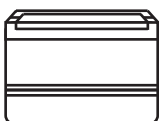

Close the Igloo Cooler

- Close the Igloo cooler until it is ready to be used.



How to Clean Credo Components:

- TIC® System (lid and base): The TIC lid and base can be cleaned using warm water and soap or alcohol. Sterilization can be performed using alcohol or other salt-based disinfectants.
- Igloo cooler lid and base, and custom insert: Insulator lid and base, and custom insert can be cleaned using a damp rag with soap or a rag with alcohol, they are also dishwasher safe.
- DO NOT:
 1. Autoclave any of the components.
 2. Use any volatile organic compounds such as acetone or methyl ethyl ketone on any of the components.
 3. Expose any of the TIC components or cellular insulator to extreme heat (+75° C or above).
 4. Use any abrasive cleaners on any of the components.

How to Validate Thermal Compliance:

Minnesota Thermal Science offers certified PC based temperature data loggers that fit inside the container and provide accurate, continuous time and temperature data in Excel format. Reference our white paper “Best Practices for Validating Thermal Performance” to validate or compare the performance of any packaging solution.

How to Inspect the Igloo Cooler Custom Insert:

Before each use verify that the custom insert is seated all of the way down inside of the cooler. Verify that the insert has not been damaged or cracked before each use.

How to Verify Components are Working Properly:

Any packaging solution should be periodically checked to ensure all components are working properly. Reference our white paper “Best Practices for Validating Thermal Performance” to validate or compare the performance of any packaging solution.

How to Inspect and Replace the Igloo Cooler:

The Igloo cooler has cellular insulation within its outer and inner plastic walls. It is very effective as long as there is no damage that can cause infiltration of outside air, nor decrease the thickness of the insulation. This is very important because insulation value is determined by its thickness.

Call 1-877-537-9800 if a component needs refurbishment.